

ROVR | OBD (Plug & Play) Install Guide

Follow the steps below to easily install a plug & play ROVR in your vehicles OBD port.

Step 1

Locate the ROVR On Board Diagnostic (OBD) port in your vehicle.

NOTE: The OBD port is usually located under the driver's side dash within two feet of the steering wheel.



Step 2

Connect the OBD end of the ROVR (A1) into the vehicle's OBD port (A2)

Your vehicle OBD Port

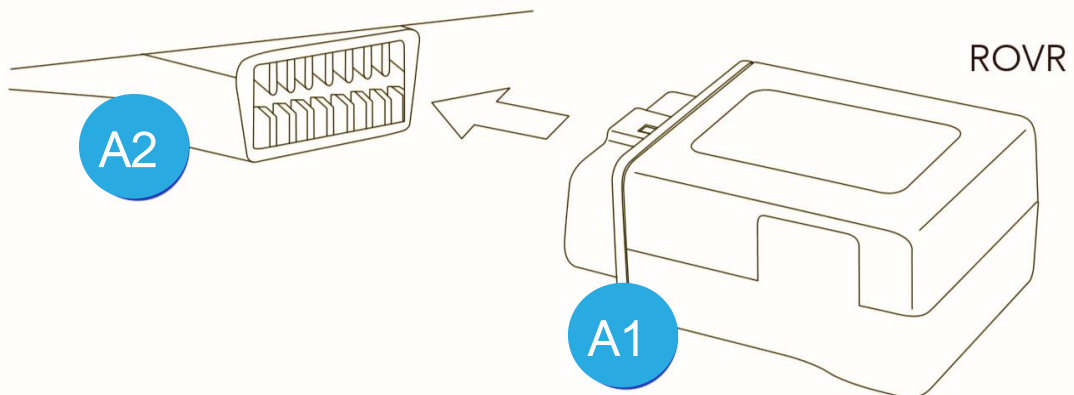

StriveSafe
By Cartasite